

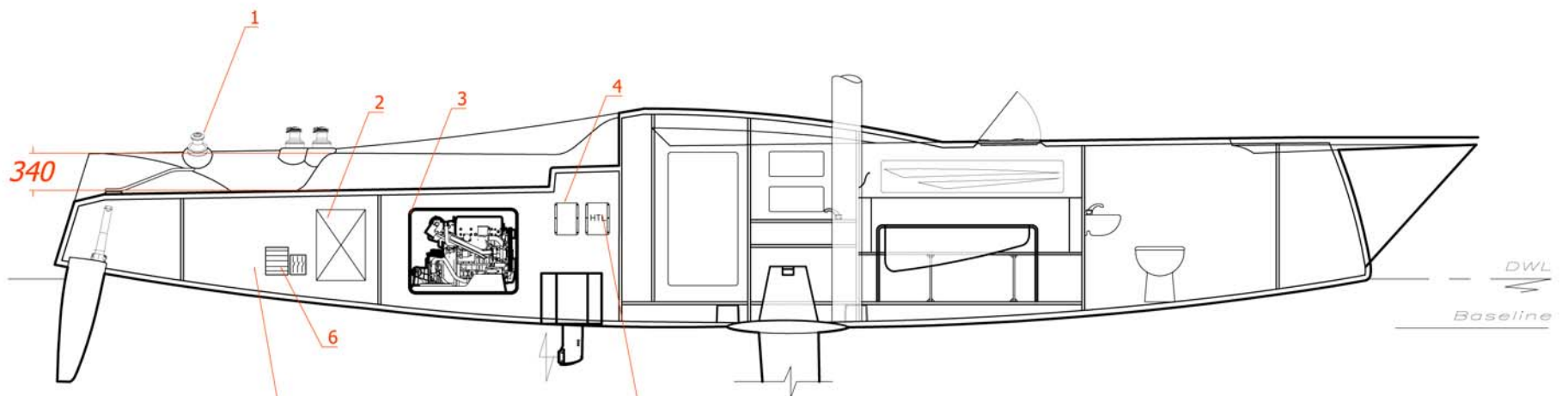

STATIONS 0 1 2 3 4 5 6 7 8 9 10 11

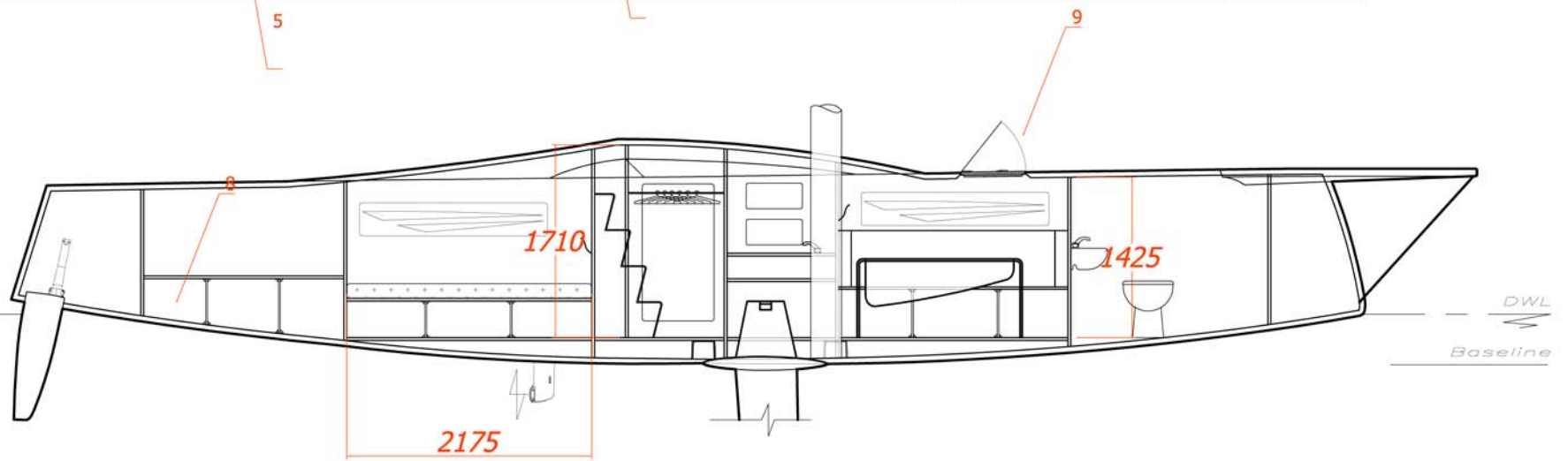

STATIONS 0 1 2 3 4 5 6 7 8 9 10 11



STATIONS 0 1 2 3 4 5 6 7 8 9 10 11

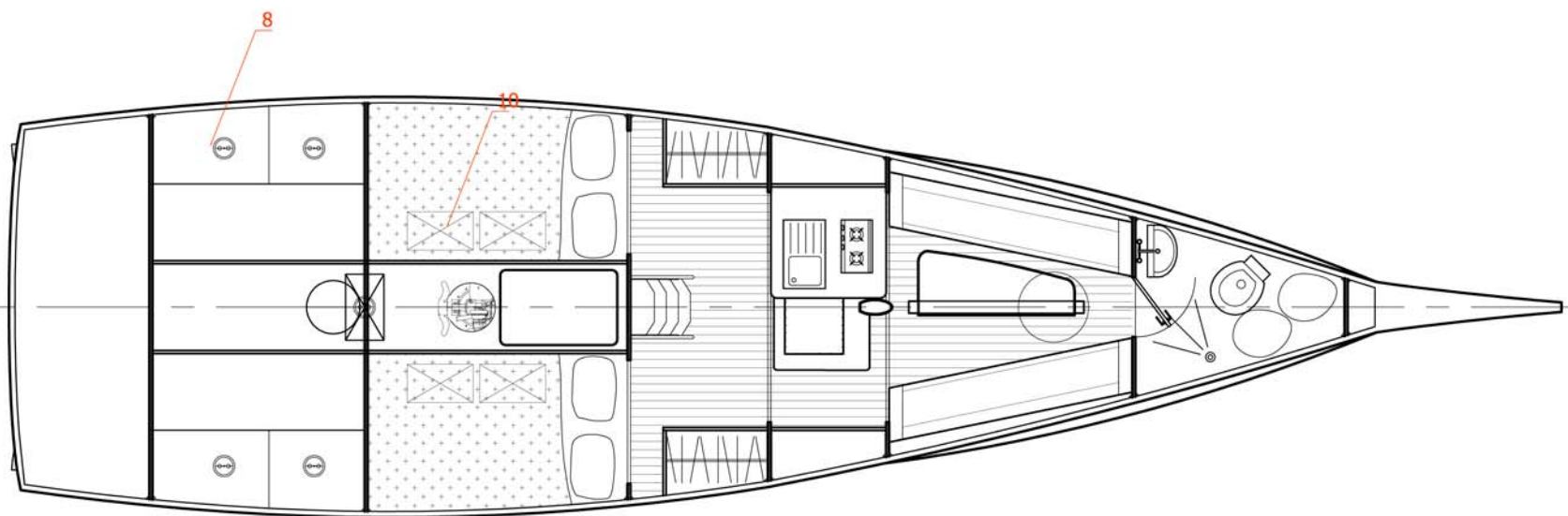

STATIONS 0 1 2 3 4 5 6 7 8 9 10 11

- 1 Harken Winch
- 2 Diesel tank
- 3 Generator
- 4 BDCE motor controller
- 5 DC/AC inverter

- 6 AC power distribution
- 7 HTL-G charge controller
- 8 Water ballast
- 9 Lewmar flush hatch
- 10 Batteries

Main Particulars

LOA	12.00 m
LWL	11.40 m
BOA	3.52 m
Draft	2.50 m
Displacement	4100 kg
Water ballast	750 litres

Upwind SA	98.0 sqm
Downwind SA	194.0 sqm
SA Main	74.0 sqm
SA Jib	24.0 sqm
SA Spi	120.0 sqm